

STEP 1 Select 'settings'.

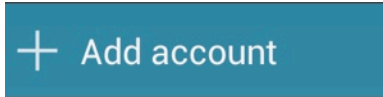

STEP 2 Select 'Add account'.



STEP 3 Select 'Email'.



STEP 4 Enter your details.

Your Avondale email address →

Your Avondale password →

Select 'Next'.

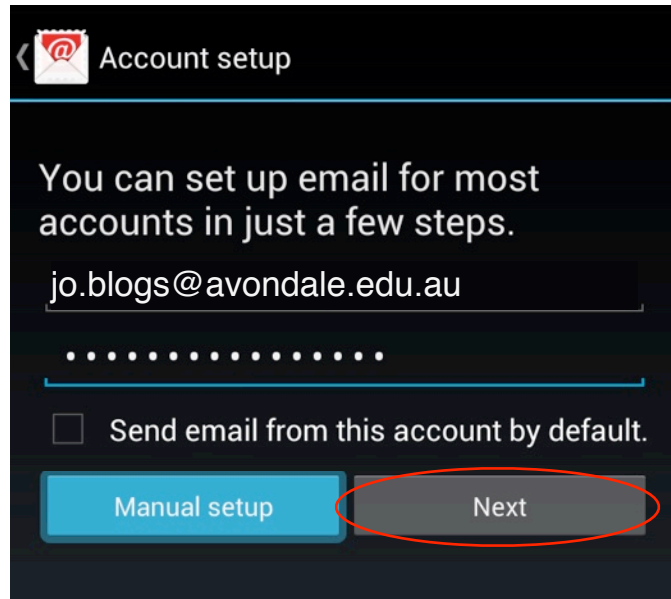

STEP 5 Select 'Exchange'.

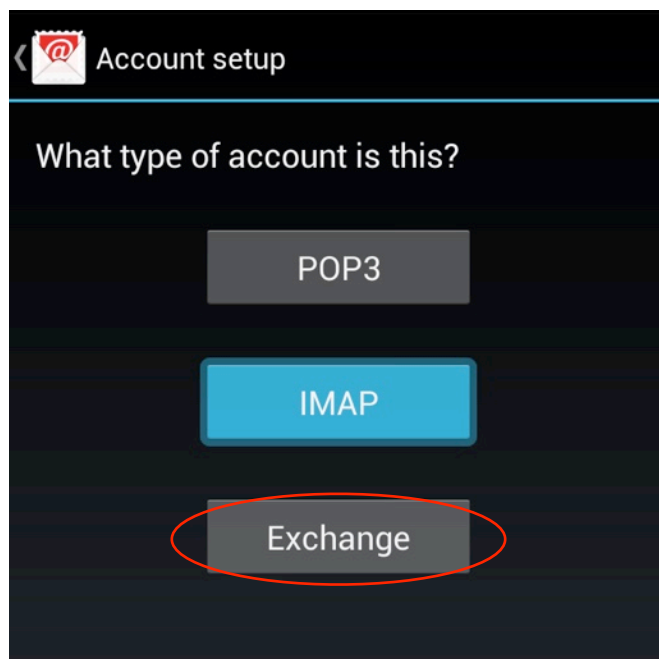

STEP 6

Configure as follows:

Your Avondale username

Your Avondale password

Select 'Next'.

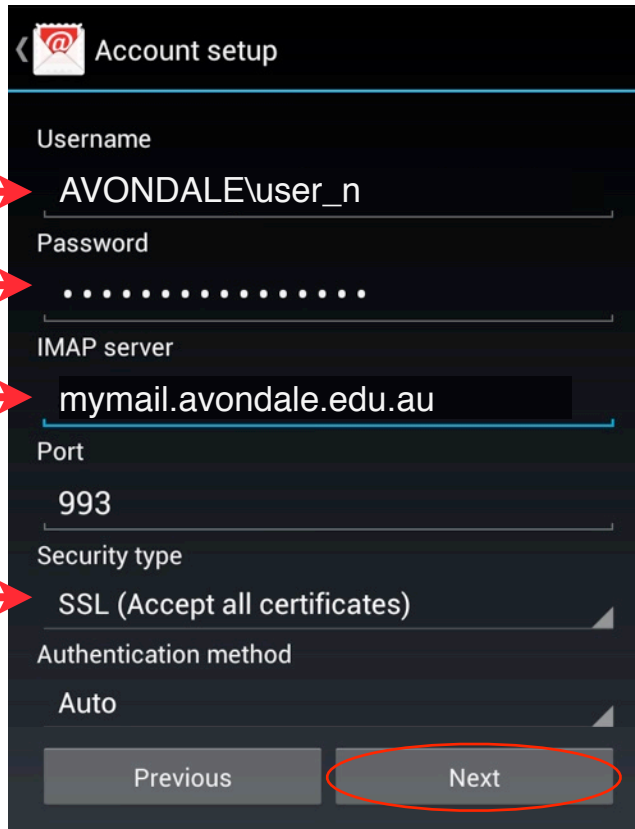

Account setup

Username: AVONDALE\user_n

Password: [masked]

IMAP server: mymail.avondale.edu.au

Port: 993

Security type: SSL (Accept all certificates)

Authentication method: Auto

Buttons: Previous, Next

Be sure to include AVONDALE\

SSL/TLS (Accept all certificates) is also supported

STEP 7

Configure as follows:

Your Avondale username

Your Avondale password

Select 'Next'.



Account setup

SMTP server: mymail.avondale.edu.au

Port: 465

Security type: SSL (Accept all certificates)

Require sign-in.

Authentication method: Auto

Username: user_n

Password: [masked]

Buttons: Previous, Next